



Valid from Dec 4th 2018 ~ Mar 31st 2019

FREE BODY

WITH A SET OF INSERTS

PHC Promotion

OSG PHOENIX PHC

Free body with a set of inserts

PHC SS - Cylindrical type

PHC - Bore type

PHC - Screw Fit type



BE-EN

KEY FEATURES: PHOENIX PHC

1 High performance

2 High feed radius cutter

3 Straight shank type



Broad Product Variations

The PHC has product variations and sizes to accommodate a wide range of machining needs. PHC achieves processing time reduction in roughing. High efficiency processing is possible even on small machining centers with low resistance specifications.

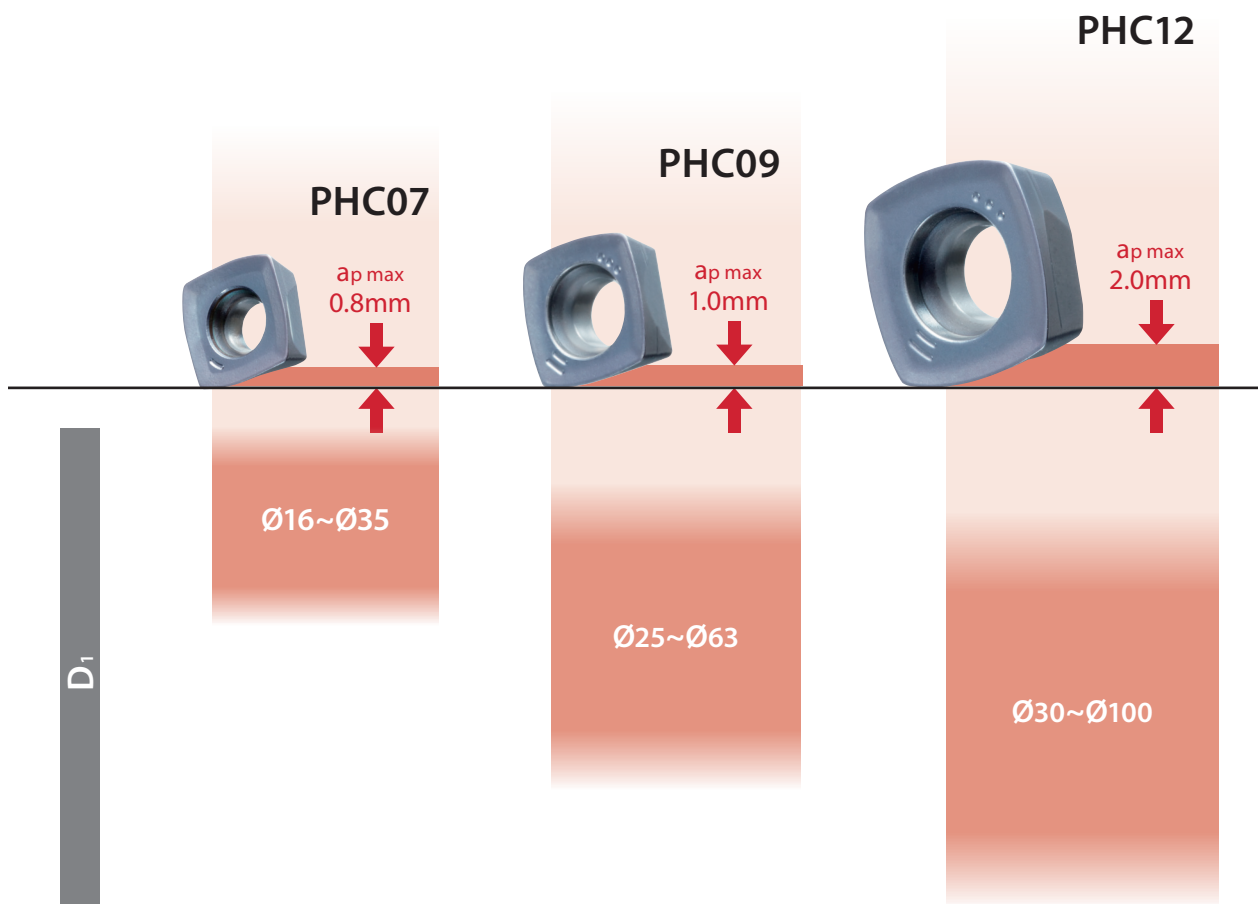

Ideal configuration for rough milling

PHC inserts have economical 4-corner design. The chipbreaker geometry enhances cutting performance while ensuring the rigidity of the cutter. Trouble-free chip evacuation capability with smooth chip control.

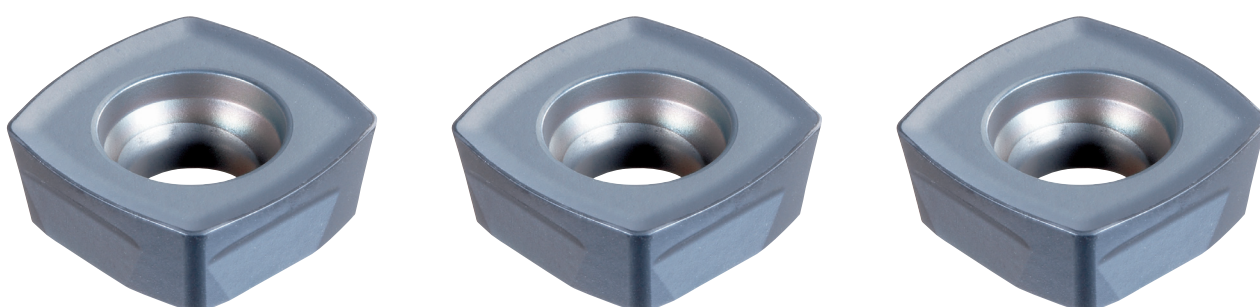

PHC SS

Milling | Indexables

FREE BODY
WITH A SET OF INSERTS



Type 1

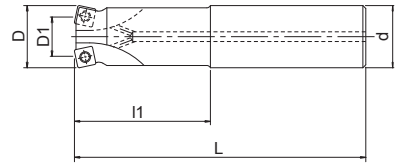

Type 2

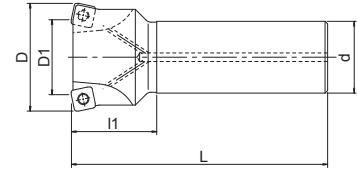

- High feed radius cutter for long over hang
- 4 corners high feed inserts
- Cylindrical type
- 16 - 40 mm



| EDP | Designation Body | List Price | BODY PROMO PRICE |
|---------|----------------------------|---------------------|------------------|
| 7800750 | PHC SS 16 PHC07R016SS16-2S | € 154,50 | FREE |
| 7800755 | PHC SS 16 PHC07R016SS16-2L | € 164,70 | |
| 7800757 | PHC SS 18 PHC07R018SS16-2L | € 164,70 | |
| 7800751 | PHC SS 20 PHC07R020SS20-3S | € 216,50 | |
| 7800758 | PHC SS 20 PHC07R020SS20-3L | € 225,80 | |
| 7800760 | PHC SS 22 PHC07R022SS20-3L | € 225,80 | |
| 7800752 | PHC SS 25 PHC07R025SS25-4S | € 275,80 | |
| 7800761 | PHC SS 25 PHC07R025SS25-4L | € 288,80 | |
| 7800753 | PHC SS 30 PHC07R030SS32-4S | € 313,80 | |
| 7800764 | PHC SS 30 PHC07R030SS32-4L | € 322,20 | |
| 7800754 | PHC SS 32 PHC07R032SS32-5S | € 344,30 | |
| 7800765 | PHC SS 32 PHC07R032SS32-5L | € 352,70 | |
| 7800767 | PHC SS 35 PHC07R035SS32-5L | € 352,70 | |

| EDP & Designation Inserts INSERT OF YOUR CHOICE | Price | INSERT QUANTITY | PROMO SET PRICE INCL. INSERTS |
|--|--------------------------------|-----------------|-------------------------------|
| + | | 20 | = € 216 |
| + | | 20 | = € 216 |
| + | 7814092 SPMT070305SR-GM XP3035 | 20 | = € 216 |
| + | 7828092 SPMT070305SR-GM XP3025 | 30 | = € 324 |
| + | 7827092 SPMT070305SR-GM XC3020 | 30 | = € 324 |
| + | 7825092 SPMT070305SR-GM XC3030 | 30 | = € 324 |
| + | 7813092 SPMT070305SR-GM XP2040 | 40 | = € 432 |
| + | 7826092 SPMT070305SR-GM XP2025 | 40 | = € 432 |
| + | 7812092 SPMT070305SR-GM XC1015 | 40 | = € 432 |
| + | | 40 | = € 432 |

| EDP | Designation Body | List Price | BODY PROMO PRICE |
|---------|----------------------------|---------------------|------------------|
| 7800750 | PHC SS 16 PHC07R016SS16-2S | € 154,50 | FREE |
| 7800755 | PHC SS 16 PHC07R016SS16-2L | € 164,70 | |
| 7800757 | PHC SS 18 PHC07R018SS16-2L | € 164,70 | |
| 7800751 | PHC SS 20 PHC07R020SS20-3S | € 216,50 | |
| 7800758 | PHC SS 20 PHC07R020SS20-3L | € 225,80 | |
| 7800760 | PHC SS 22 PHC07R022SS20-3L | € 225,80 | |
| 7800752 | PHC SS 25 PHC07R025SS25-4S | € 275,80 | |
| 7800761 | PHC SS 25 PHC07R025SS25-4L | € 288,80 | |
| 7800753 | PHC SS 30 PHC07R030SS32-4S | € 313,80 | |
| 7800764 | PHC SS 30 PHC07R030SS32-4L | € 322,20 | |
| 7800754 | PHC SS 32 PHC07R032SS32-5S | € 344,30 | |
| 7800765 | PHC SS 32 PHC07R032SS32-5L | € 352,70 | |
| 7800767 | PHC SS 35 PHC07R035SS32-5L | € 352,70 | |

| EDP & Designation Inserts INSERT OF YOUR CHOICE | Price | INSERT QUANTITY | PROMO SET PRICE INCL. INSERTS |
|--|--------------------------------|-----------------|-------------------------------|
| + | | 10 | = € 198 |
| + | | 10 | = € 198 |
| + | | 10 | = € 198 |
| + | | 20 | = € 396 |
| + | | 20 | = € 396 |
| + | | 20 | = € 396 |
| + | 7816093 SPMT070305ER-SM XC5040 | 20 | = € 396 |
| + | | 20 | = € 396 |
| + | | 20 | = € 396 |
| + | | 20 | = € 396 |
| + | | 20 | = € 396 |
| + | | 20 | = € 396 |
| + | | 20 | = € 396 |

Milling | Indexables



PHC SS

PHC SS

Milling | Indexables

FREE BODY
WITH A SET OF INSERTS

| EDP | Designation Body | List Price | BODY PROMO PRICE |
|---------|----------------------------|---------------------|------------------|
| 7800700 | PHC SS 25 PHC09R025SS25-2S | € 225,10 | FREE |
| 7800704 | PHC SS 25 PHC09R025SS25-2L | € 283,50 | |
| 7800701 | PHC SS 25 PHC09R025SS25-3S | € 253,60 | |
| 7800705 | PHC SS 25 PHC09R025SS25-3L | € 299,40 | |
| 7800716 | PHC SS 28 PHC09R028SS25-3S | € 359,90 | |
| 7800720 | PHC SS 28 PHC09R028SS25-3L | € 369,50 | |
| 7800717 | PHC SS 30 PHC09R030SS32-3S | € 374,10 | |
| 7800721 | PHC SS 30 PHC09R030SS32-3L | € 477,70 | |
| 7800702 | PHC SS 32 PHC09R032SS32-3S | € 268,10 | |
| 7800706 | PHC SS 32 PHC09R032SS32-3L | € 316,80 | |
| 7800718 | PHC SS 35 PHC09R035SS32-3S | € 387,80 | |
| 7800722 | PHC SS 35 PHC09R035SS32-3L | € 477,70 | |
| 7800703 | PHC SS 40 PHC09R040SS32-4S | € 319,20 | |
| 7800730 | PHC SS 30 PHC12R030SS32-2S | € 364,50 | |
| 7800708 | PHC SS 32 PHC12R032SS32-2S | € 242,70 | |
| 7800731 | PHC SS 35 PHC12R035SS32-3S | € 324,40 | |
| 7800709 | PHC SS 40 PHC12R040SS32-3S | € 291,80 | |

| EDP & Designation Inserts INSERT OF YOUR CHOICE | Price | INSERT QUANTITY | PROMO SET PRICE INCL. INSERTS |
|--|---------|-----------------|-------------------------------|
| | | 30 | = € 339 |
| | | 30 | = € 339 |
| | | 30 | = € 339 |
| | | 30 | = € 339 |
| | | 40 | = € 452 |
| | | 40 | = € 452 |
| | | 40 | = € 452 |
| | | 40 | = € 452 |
| 7825020 SDMT09T308SR-GM XC3030 | € 11,30 | 50 | = € 565 |
| 7826020 SDMT09T308SR-GM XP2025 | | 30 | = € 339 |
| | | 40 | = € 452 |
| | | 40 | = € 452 |
| | | 50 | = € 565 |
| | | 40 | = € 452 |
| | | 40 | = € 452 |
| | | 30 | = € 339 |
| | | 40 | = € 452 |
| | | 30 | = € 339 |



| EDP | Designation Body | List Price | BODY PROMO PRICE |
|---------|----------------------------|---------------------|------------------|
| 7800700 | PHC SS 25 PHC09R025SS25-2S | € 225,10 | FREE |
| 7800704 | PHC SS 25 PHC09R025SS25-2L | € 283,50 | |
| 7800701 | PHC SS 25 PHC09R025SS25-3S | € 253,60 | |
| 7800705 | PHC SS 25 PHC09R025SS25-3L | € 299,40 | |
| 7800716 | PHC SS 28 PHC09R028SS25-3S | € 359,90 | |
| 7800720 | PHC SS 28 PHC09R028SS25-3L | € 369,50 | |
| 7800717 | PHC SS 30 PHC09R030SS32-3S | € 374,10 | |
| 7800721 | PHC SS 30 PHC09R030SS32-3L | € 477,70 | |
| 7800702 | PHC SS 32 PHC09R032SS32-3S | € 268,10 | |
| 7800706 | PHC SS 32 PHC09R032SS32-3L | € 316,80 | |
| 7800718 | PHC SS 35 PHC09R035SS32-3S | € 387,80 | |
| 7800703 | PHC SS 40 PHC09R040SS32-4S | € 319,20 | |
| 7800730 | PHC SS 30 PHC12R030SS32-2S | € 364,50 | |
| 7800708 | PHC SS 32 PHC12R032SS32-2S | € 242,70 | |
| 7800731 | PHC SS 35 PHC12R035SS32-3S | € 324,40 | |
| 7800709 | PHC SS 40 PHC12R040SS32-3S | € 291,80 | |

| EDP & Designation Inserts INSERT OF YOUR CHOICE | Price | INSERT QUANTITY | PROMO SET PRICE INCL. INSERTS |
|--|---------|-----------------|-------------------------------|
| | | 30 | = € 351 |
| | | 30 | = € 351 |
| | | 30 | = € 351 |
| | | 30 | = € 351 |
| | | 40 | = € 468 |
| | | 40 | = € 468 |
| | | 40 | = € 468 |
| 7814020 SDMT09T308SR-GM XP3035 | € 11,70 | 50 | = € 585 |
| 7813020 SDMT09T308SR-GM XP2040 | | 30 | = € 351 |
| 7812020 SDMT09T308SR-GM XC1015 | | 30 | = € 351 |
| | | 40 | = € 468 |
| | | 40 | = € 468 |
| | | 40 | = € 468 |
| | | 40 | = € 468 |
| | | 30 | = € 351 |
| | | 40 | = € 468 |
| | | 30 | = € 351 |

| EDP | Designation Body | List Price | BODY PROMO PRICE |
|---------|----------------------------|---------------------|------------------|
| 7800700 | PHC SS 25 PHC09R025SS25-2S | € 225,10 | FREE |
| 7800704 | PHC SS 25 PHC09R025SS25-2L | € 283,50 | |
| 7800701 | PHC SS 25 PHC09R025SS25-3S | € 253,60 | |
| 7800705 | PHC SS 25 PHC09R025SS25-3L | € 299,40 | |
| 7800716 | PHC SS 28 PHC09R028SS25-3S | € 359,90 | |
| 7800720 | PHC SS 28 PHC09R028SS25-3L | € 369,50 | |
| 7800717 | PHC SS 30 PHC09R030SS32-3S | € 374,10 | |
| 7800721 | PHC SS 30 PHC09R030SS32-3L | € 477,70 | |
| 7800702 | PHC SS 32 PHC09R032SS32-3S | € 268,10 | |
| 7800706 | PHC SS 32 PHC09R032SS32-3L | € 316,80 | |
| 7800718 | PHC SS 35 PHC09R035SS32-3S | € 387,80 | |
| 7800722 | PHC SS 35 PHC09R035SS32-3L | € 477,70 | |
| 7800703 | PHC SS 40 PHC09R040SS32-4S | € 319,20 | |
| 7800730 | PHC SS 30 PHC12R030SS32-2S | € 364,50 | |
| 7800708 | PHC SS 32 PHC12R032SS32-2S | € 242,70 | |
| 7800731 | PHC SS 35 PHC12R035SS32-3S | € 324,40 | |
| 7800709 | PHC SS 40 PHC12R040SS32-3S | € 291,80 | |

| EDP & Designation Inserts INSERT OF YOUR CHOICE | Price | INSERT QUANTITY | PROMO SET PRICE INCL. INSERTS |
|--|---------|-----------------|-------------------------------|
| | | 20 | = € 352 |
| | | 20 | = € 352 |
| | | 20 | = € 352 |
| | | 20 | = € 352 |
| | | 30 | = € 528 |
| | | 30 | = € 528 |
| | | 30 | = € 528 |
| 7815021 SDMT09T308ER-SM XC5035 | € 17,60 | 30 | = € 528 |
| 7816021 SDMT09T308ER-SM XC5040 | | 20 | = € 352 |
| | | 20 | = € 352 |
| | | 30 | = € 528 |
| | | 30 | = € 528 |
| | | 20 | = € 352 |
| | | 30 | = € 528 |
| | | 20 | = € 352 |
| | | 30 | = € 528 |
| | | 20 | = € 352 |

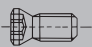
Accessories & spare parts

| Applicable cutter |  Clamping screw | |  Wrench | |
|-------------------|--|-------------------|--|-----------------|
| | EDP | Designation | EDP | Designation |
| SPMT07 Ø 16 ~ 35 | 7808105 | FS25550 (Torx 8) | 7808205 | T8-D (Torx 8) |
| SDMT09 Ø 25 ~ 35 | 7808111 | FS35572 (Torx 15) | 7808208 | T15-D (Torx 15) |
| SDMT09 Ø 40 | 7808112 | FS35586 (Torx 15) | 7808208 | T15-D (Torx 15) |
| SXMT12 Ø 30 ~ 40 | 7808113 | FS45510 (Torx 20) | 7808209 | T20-D (Torx 20) |
| | | | | |

Milling | Indexables



PHC SS

PHC BORE

Milling | Indexables



- High feed radius cutter for long over hang
- 4 corners high feed inserts
- Bore types
- 40 - 100 mm

Type 1

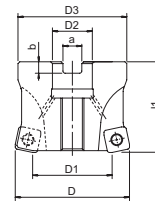

Type 2

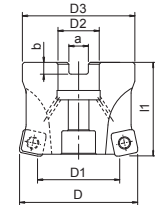

| EDP | Designation Body | List Price | BODY PROMO PRICE |
|---------|-----------------------------|------------|------------------|
| 7800600 | PHC BORE 40 PHC09R040M16-4 | € 351,30 | FREE |
| 7800601 | PHC BORE 50 PHC09R050M22-5 | € 422,60 | |
| 7800602 | PHC BORE 52 PHC09R052M22-5 | € 443,70 | |
| 7800603 | PHC BORE 63 PHC09R063M22-6 | € 486,00 | |
| 7800604 | PHC BORE 66 PHC09R066M22-7 | € 505,40 | |
| 7800607 | PHC BORE 40 PHC12R040M16-3 | € 330,50 | |
| 7800608 | PHC BORE 50 PHC12R050M22-4 | € 401,40 | |
| 7800609 | PHC BORE 52 PHC12R052M22-4 | € 422,60 | |
| 7800610 | PHC BORE 63 PHC12R063M22-5 | € 463,20 | |
| 7800611 | PHC BORE 66 PHC12R066M22-6 | € 486,00 | |
| 7800612 | PHC BORE 80 PHC12R080M27-7 | € 543,40 | |
| 7800613 | PHC BORE 100 PHC12R100M32-8 | € 603,70 | |

| EDP & Designation Inserts INSERT OF YOUR CHOICE | Price | INSERT QUANTITY | PROMO SET PRICE INCL. INSERTS |
|--|---------|-----------------|-------------------------------|
| | | 40 | € 452 |
| | | 50 | € 565 |
| | | 50 | € 565 |
| | | 50 | € 565 |
| | | 50 | € 565 |
| 7825020 SDMT09T308SR-GM XC3030 | € 11,30 | 40 | € 452 |
| 7826020 SDMT09T308SR-GM XP2025 | | 40 | € 452 |
| | | 50 | € 565 |
| | | 50 | € 565 |
| | | 50 | € 565 |
| | | 50 | € 565 |
| | | 60 | € 678 |
| | | 60 | € 678 |

| EDP | Designation Body | List Price | BODY PROMO PRICE |
|---------|----------------------------|------------|------------------|
| 7800600 | PHC BORE 40 PHC09R040M16-4 | € 351,30 | FREE |
| 7800601 | PHC BORE 50 PHC09R050M22-5 | € 422,60 | |
| 7800602 | PHC BORE 52 PHC09R052M22-5 | € 443,70 | |
| 7800603 | PHC BORE 63 PHC09R063M22-6 | € 486,00 | |
| 7800604 | PHC BORE 66 PHC09R066M22-7 | € 505,40 | |

| EDP & Designation Inserts INSERT OF YOUR CHOICE | Price | INSERT QUANTITY | PROMO SET PRICE INCL. INSERTS |
|--|---------|-----------------|-------------------------------|
| 7814020 SDMT09T308SR-GM XP3035 | € 11,70 | 40 | € 468 |
| 7813020 SDMT09T308SR-GM XP2040 | | 50 | € 585 |
| 7812020 SDMT09T308SR-GM XC1015 | | 50 | € 585 |
| | | 50 | € 585 |

| EDP | Designation Body | List Price | BODY PROMO PRICE |
|---------|-----------------------------|------------|------------------|
| 7800607 | PHC BORE 40 PHC12R040M16-3 | € 330,50 | FREE |
| 7800608 | PHC BORE 50 PHC12R050M22-4 | € 401,40 | |
| 7800609 | PHC BORE 52 PHC12R052M22-4 | € 422,60 | |
| 7800610 | PHC BORE 63 PHC12R063M22-5 | € 463,20 | |
| 7800611 | PHC BORE 66 PHC12R066M22-6 | € 486,00 | |
| 7800612 | PHC BORE 80 PHC12R080M27-7 | € 543,40 | |
| 7800613 | PHC BORE 100 PHC12R100M32-8 | € 603,70 | |

| EDP & Designation Inserts INSERT OF YOUR CHOICE | Price | INSERT QUANTITY | PROMO SET PRICE INCL. INSERTS |
|--|---------|-----------------|-------------------------------|
| 7814022 XP3035 SXMT120410SR-GM | € 13,50 | 30 | € 405 |
| | | 40 | € 540 |
| 7813022 XP2040 SXMT120410SR-GM | | 40 | € 540 |
| 7812022 XC1015 SXMT120410SR-GM | | 40 | € 540 |
| | | 50 | € 675 |
| | | 50 | € 675 |

| EDP | Designation Body | List Price | BODY PROMO PRICE |
|---------|----------------------------|------------|------------------|
| 7800600 | PHC BORE 40 PHC09R040M16-4 | € 351,30 | FREE |
| 7800601 | PHC BORE 50 PHC09R050M22-5 | € 422,60 | |
| 7800602 | PHC BORE 52 PHC09R052M22-5 | € 443,70 | |
| 7800604 | PHC BORE 66 PHC09R066M22-7 | € 505,40 | |

| EDP & Designation Inserts INSERT OF YOUR CHOICE | Price | INSERT QUANTITY | PROMO SET PRICE INCL. INSERTS |
|--|---------|-----------------|-------------------------------|
| 7815021 SDMT09T308ER-SM XC5035 | € 17,60 | 30 | € 528 |
| 7816021 SDMT09T308ER-SM XC5040 | | 30 | € 528 |
| | | 30 | € 528 |
| | | 40 | € 704 |

| EDP | Designation Body | List Price | BODY PROMO PRICE |
|---------|-----------------------------|------------|------------------|
| 7800607 | PHC BORE 40 PHC12R040M16-3 | € 330,50 | FREE |
| 7800608 | PHC BORE 50 PHC12R050M22-4 | € 401,40 | |
| 7800609 | PHC BORE 52 PHC12R052M22-4 | € 422,60 | |
| 7800610 | PHC BORE 63 PHC12R063M22-5 | € 463,20 | |
| 7800611 | PHC BORE 66 PHC12R066M22-6 | € 486,00 | |
| 7800612 | PHC BORE 80 PHC12R080M27-7 | € 543,40 | |
| 7800613 | PHC BORE 100 PHC12R100M32-8 | € 603,70 | |

| EDP & Designation Inserts INSERT OF YOUR CHOICE | Price | INSERT QUANTITY | PROMO SET PRICE INCL. INSERTS |
|--|---------|-----------------|-------------------------------|
| 7815023 SXMT120410ER-SM XC5035 | € 21,70 | 20 | € 434 |
| | | 30 | € 651 |
| 7816023 SXMT120410ER-SM XC5040 | | 30 | € 651 |
| | | 30 | € 651 |
| | | 30 | € 651 |
| | | 30 | € 651 |
| | | 40 | € 868 |

Milling | Indexables

Bore

PHC SCREW FIT

Milling | Indexables

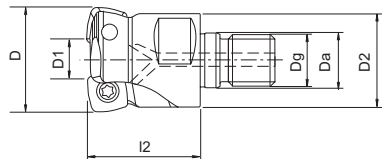

- High feed radius cutter for long over hang
- 4 corners high feed inserts
- Screw fit type
- 16 - 40 mm





| EDP | Designation Body | List Price | BODY PROMO PRICE |
|---------|----------------------------------|---------------------|------------------|
| 7801520 | PHC SCREW FIT 16 PHC07R016SF8-2 | € 149,90 | FREE |
| 7801523 | PHC SCREW FIT 20 PHC07R020SF10-3 | € 210,20 | |
| 7801525 | PHC SCREW FIT 22 PHC07R022SF10-3 | € 210,20 | |
| 7801526 | PHC SCREW FIT 25 PHC07R025SF12-4 | € 267,60 | |
| 7801529 | PHC SCREW FIT 30 PHC07R030SF16-4 | € 304,50 | |
| 7801530 | PHC SCREW FIT 32 PHC07R032SF16-5 | € 334,20 | |
| 7801532 | PHC SCREW FIT 35 PHC07R035SF16-5 | € 334,20 | |

| EDP & Designation Inserts INSERT OF YOUR CHOICE | Price | INSERT QUANTITY | PROMO SET PRICE INCL. INSERTS |
|--|---------|-----------------|-------------------------------|
| + 7814092 SPMT070305SR-GM XP3035 | € 10,80 | 20 | = € 216 |
| + 7828092 SPMT070305SR-GM XP3025 | | 30 | = € 324 |
| + 7827092 SPMT070305SR-GM XC3020 | | 30 | = € 324 |
| + 7825092 SPMT070305SR-GM XC3030 | | 30 | = € 324 |
| + 7813092 SPMT070305SR-GM XP2040 | | 40 | = € 432 |
| + 7826092 SPMT070305SR-GM XP2025 | | 40 | = € 432 |
| + 7812092 SPMT070305SR-GM XC1015 | | 40 | = € 432 |

| EDP | Designation Body | List Price | BODY PROMO PRICE |
|---------|----------------------------------|---------------------|------------------|
| 7801520 | PHC SCREW FIT 16 PHC07R016SF8-2 | € 149,90 | FREE |
| 7801523 | PHC SCREW FIT 20 PHC07R020SF10-3 | € 210,20 | |
| 7801525 | PHC SCREW FIT 22 PHC07R022SF10-3 | € 210,20 | |
| 7801526 | PHC SCREW FIT 25 PHC07R025SF12-4 | € 267,60 | |
| 7801529 | PHC SCREW FIT 30 PHC07R030SF16-4 | € 304,50 | |
| 7801530 | PHC SCREW FIT 32 PHC07R032SF16-5 | € 334,20 | |
| 7801532 | PHC SCREW FIT 35 PHC07R035SF16-5 | € 334,20 | |

| EDP & Designation Inserts INSERT OF YOUR CHOICE | Price | INSERT QUANTITY | PROMO SET PRICE INCL. INSERTS |
|--|---------|-----------------|-------------------------------|
| + 7815023 XC5035 SXMT120410ER-SM | € 19,80 | 10 | = € 198 |
| + 7816023 XC5040 SXMT120410ER-SM | | 20 | = € 396 |
| | | 20 | = € 396 |
| | | 20 | = € 396 |
| | | 20 | = € 396 |
| | | 20 | = € 396 |
| | | 20 | = € 396 |
| | | 20 | = € 396 |

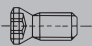
Accessories & spare parts

| Applicable cutter |  Clamping screw | |  Wrench | |
|-------------------|---|-------------------|---|-----------------|
| SPMT07 Ø 16 ~ 35 | 7808105 | FS25550 (Torx 8) | 7808205 | T8-D (Torx 8) |
| SDMT09 Ø 25 ~ 35 | 7808111 | FS35572 (Torx 15) | 7808208 | T15-D (Torx 15) |
| SDMT09 Ø 40 | 7808112 | FS35586 (Torx 15) | 7808208 | T15-D (Torx 15) |
| SDMT12 Ø 30 ~ 63 | 7808113 | FS45510 (Torx 20) | 7808209 | T20-D (Torx 20) |
| | | | | |
| | | | | |

Milling | Indexables
Screw Fit



PHC SCREW FIT

Milling | Indexables

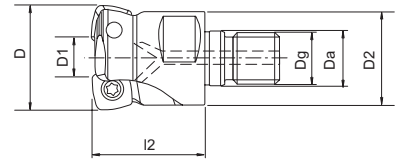

- High feed radius cutter for long over hang
- 4 corners high feed inserts
- Screw fit type
- 16 - 40 mm



Milling | Indexables



Screw Fit

| EDP | Designation Body | List Price | BODY PROMO PRICE |
|---------|----------------------------------|---------------------|------------------|
| 7801500 | PHC SCREW FIT 25 PHC09R025SF12-3 | € 357,70 | FREE |
| 7801501 | PHC SCREW FIT 28 PHC09R028SF12-3 | € 357,70 | |
| 7801502 | PHC SCREW FIT 30 PHC09R030SF16-3 | € 393,50 | |
| 7801503 | PHC SCREW FIT 32 PHC09R032SF16-3 | € 393,50 | |
| 7801504 | PHC SCREW FIT 35 PHC09R035SF16-3 | € 393,50 | |
| 7801505 | PHC SCREW FIT 40 PHC09R040SF16-4 | € 483,70 | |

| EDP & Designation Inserts INSERT OF YOUR CHOICE | Price | INSERT QUANTITY | PROMO SET PRICE INCL. INSERTS |
|--|---------|-----------------|-------------------------------------|
| + | € 11,30 | 40 | = € 452 |
| | | 40 | = € 452 |
| | | 40 | = € 452 |
| | | 40 | = € 452 |
| | | 50 | = € 565 |

| EDP | Designation Body | List Price | BODY PROMO PRICE |
|---------|----------------------------------|---------------------|------------------|
| 7801506 | PHC SCREW FIT 30 PHC12R030SF16-2 | € 357,70 | FREE |
| 7801507 | PHC SCREW FIT 32 PHC12R032SF16-2 | € 357,70 | |
| 7801508 | PHC SCREW FIT 35 PHC12R035SF16-3 | € 433,20 | |
| 7801509 | PHC SCREW FIT 40 PHC12R040SF16-3 | € 442,70 | |

| EDP & Designation Inserts INSERT OF YOUR CHOICE | Price | INSERT QUANTITY | PROMO SET PRICE INCL. INSERTS |
|--|---------|-----------------|-------------------------------------|
| + | € 13,20 | 40 | = € 528 |
| | | 40 | = € 528 |
| | | 40 | = € 528 |
| | | 40 | = € 528 |

| EDP | Designation Body | List Price | BODY PROMO PRICE |
|---------|----------------------------------|---------------------|------------------|
| 7801500 | PHC SCREW FIT 25 PHC09R025SF12-3 | € 357,70 | FREE |
| 7801501 | PHC SCREW FIT 28 PHC09R028SF12-3 | € 357,70 | |
| 7801502 | PHC SCREW FIT 30 PHC09R030SF16-3 | € 393,50 | |
| 7801503 | PHC SCREW FIT 32 PHC09R032SF16-3 | € 393,50 | |
| 7801504 | PHC SCREW FIT 35 PHC09R035SF16-3 | € 393,50 | |
| 7801505 | PHC SCREW FIT 40 PHC09R040SF16-4 | € 483,70 | |

| EDP & Designation Inserts INSERT OF YOUR CHOICE | Price | INSERT QUANTITY | PROMO SET PRICE INCL. INSERTS |
|--|---------|-----------------|-------------------------------------|
| + | € 11,70 | 40 | = € 468 |
| | | 40 | = € 468 |
| | | 40 | = € 468 |
| | | 40 | = € 468 |
| | | 50 | = € 585 |

| EDP | Designation Body | List Price | BODY PROMO PRICE |
|---------|----------------------------------|---------------------|------------------|
| 7801506 | PHC SCREW FIT 30 PHC12R030SF16-2 | € 357,70 | FREE |
| 7801507 | PHC SCREW FIT 32 PHC12R032SF16-2 | € 357,70 | |
| 7801508 | PHC SCREW FIT 35 PHC12R035SF16-3 | € 433,20 | |
| 7801509 | PHC SCREW FIT 40 PHC12R040SF16-3 | € 442,70 | |

| EDP & Designation Inserts INSERT OF YOUR CHOICE | Price | INSERT QUANTITY | PROMO SET PRICE INCL. INSERTS |
|--|---------|-----------------|-------------------------------------|
| + | € 13,50 | 30 | = € 405 |
| | | 30 | = € 405 |
| | | 40 | = € 540 |
| | | 40 | = € 540 |

| EDP | Designation Body | List Price | BODY PROMO PRICE |
|---------|----------------------------------|---------------------|------------------|
| 7801500 | PHC SCREW FIT 25 PHC09R025SF12-3 | € 357,70 | FREE |
| 7801501 | PHC SCREW FIT 28 PHC09R028SF12-3 | € 357,70 | |
| 7801502 | PHC SCREW FIT 30 PHC09R030SF16-3 | € 393,50 | |
| 7801503 | PHC SCREW FIT 32 PHC09R032SF16-3 | € 393,50 | |
| 7801504 | PHC SCREW FIT 35 PHC09R035SF16-3 | € 393,50 | |
| 7801505 | PHC SCREW FIT 40 PHC09R040SF16-4 | € 483,70 | |

| EDP & Designation Inserts INSERT OF YOUR CHOICE | Price | INSERT QUANTITY | PROMO SET PRICE INCL. INSERTS |
|--|---------|-----------------|-------------------------------------|
| + | € 17,60 | 30 | = € 528 |
| | | 30 | = € 528 |
| | | 30 | = € 528 |
| | | 30 | = € 528 |
| | | 40 | = € 704 |

| EDP | Designation Body | List Price | BODY PROMO PRICE |
|---------|----------------------------------|---------------------|------------------|
| 7801506 | PHC SCREW FIT 30 PHC12R030SF16-2 | € 357,70 | FREE |
| 7801507 | PHC SCREW FIT 32 PHC12R032SF16-2 | € 357,70 | |
| 7801508 | PHC SCREW FIT 35 PHC12R035SF16-3 | € 433,20 | |
| 7801509 | PHC SCREW FIT 40 PHC12R040SF16-3 | € 442,70 | |

| EDP & Designation Inserts INSERT OF YOUR CHOICE | Price | INSERT QUANTITY | PROMO SET PRICE INCL. INSERTS |
|--|---------|-----------------|-------------------------------------|
| + | € 21,70 | 20 | = € 434 |
| | | 20 | = € 434 |
| | | 30 | = € 651 |

PHC INSERTS

Milling | Indexables

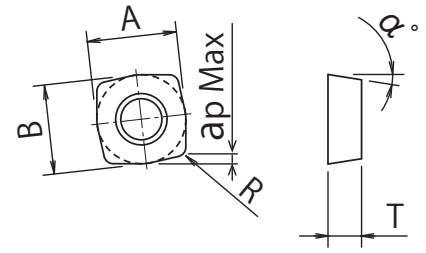

- High feed radius cutter for long over hang
- 4 corners inserts

| EDP | Designation | Z | A x B | T | α | R | ap max | Grade | P | | M | | K | | N | | S | | H | | Price | |
|---------|-----------------|---|-----------|------|-----|-----|--------|--------|-----|-----|-----|-----|----|-----|-----|-----|-----|-----|-----|-----|-------|--|
| | | | | | | | | | dry | oil | dry | oil | GG | GGG | dry | oil | dry | oil | dry | oil | | |
| 7814092 | SPMT070305SR-GM | 4 | 7x7 | 2,75 | 11° | 0,5 | 0,8 | XP3035 | ● | ● | ○ | ○ | ○ | ○ | | | | | | | | |
| 7828092 | SPMT070305SR-GM | 4 | 7x7 | 2,75 | 11° | 0,5 | 0,8 | XP3025 | ● | ● | ○ | ○ | ○ | ○ | | | | | | | | |
| 7827092 | SPMT070305SR-GM | 4 | 7x7 | 2,75 | 11° | 0,5 | 0,8 | XC3020 | ● | ● | ○ | ○ | ○ | ○ | | | | | | | | |
| 7825092 | SPMT070305SR-GM | 4 | 7x7 | 2,75 | 11° | 0,5 | 0,8 | XC3030 | ● | ● | ○ | ○ | ○ | ○ | | | | | | | | |
| 7813092 | SPMT070305SR-GM | 4 | 7x7 | 2,75 | 11° | 0,5 | 0,8 | XP2040 | ○ | ○ | ○ | ● | | | | | | ○ | ○ | | | |
| 7826092 | SPMT070305SR-GM | 4 | 7x7 | 2,75 | 11° | 0,5 | 0,8 | XP2025 | ○ | ○ | ○ | ● | | | | | | | | | | |
| 7816093 | SPMT070305ER-SM | 4 | 7x7 | 2,75 | 11° | 0,5 | 0,8 | XC5040 | | | ○ | | | | | | | ● | | | | |
| 7812092 | SPMT070305SR-GM | 4 | 7x7 | 2,75 | 11° | 0,5 | 0,8 | XC1015 | | | | | ● | ● | | | | | | | | |
| 7814020 | SDMT09T308SR-GM | 4 | 9,52x9,52 | 3,97 | 15° | 0,8 | 1 | XP3035 | ● | ● | ○ | ○ | ○ | ○ | | | | | | | | |
| 7825020 | SDMT09T308SR-GM | 4 | 9,52x9,52 | 3,97 | 15° | 0,8 | 1 | XC3030 | ● | ● | ○ | ○ | ○ | ○ | | | | | | | | |
| 7813020 | SDMT09T308SR-GM | 4 | 9,52x9,52 | 3,97 | 15° | 0,8 | 1 | XP2040 | ○ | ○ | ○ | ● | | | | | | ○ | ○ | | | |
| 7826020 | SDMT09T308SR-GM | 4 | 9,52x9,52 | 3,97 | 15° | 0,8 | 1 | XP2025 | ○ | ○ | ○ | ● | | | | | | | | | | |
| 7815021 | SDMT09T308ER-SM | 4 | 9,52x9,52 | 3,97 | 15° | 0,8 | 1 | XC5035 | | | ○ | | | | | | | ○ | ○ | | | |
| 7816021 | SDMT09T308ER-SM | 4 | 9,52x9,52 | 3,97 | 15° | 0,8 | 1 | XC5040 | | | ○ | | | | | | | ● | | | | |
| 7812020 | SDMT09T308SR-GM | 4 | 9,52x9,52 | 3,97 | 15° | 0,8 | 1 | XC1015 | | | | | ● | ● | | | | | | | | |
| 7814022 | SXMT120410SR-GM | 4 | 12,7x12,7 | 4,76 | 9° | 1 | 2 | XP3035 | ● | ● | ○ | ○ | ○ | ○ | | | | | | | | |
| 7825022 | SXMT120410SR-GM | 4 | 12,7x12,7 | 4,76 | 9° | 1 | 2 | XC3030 | ● | ● | ○ | ○ | ○ | ○ | | | | | | | | |
| 7813022 | SXMT120410SR-GM | 4 | 12,7x12,7 | 4,76 | 9° | 1 | 2 | XP2040 | ○ | ○ | ○ | ● | | | | | | ○ | ○ | | | |
| 7826022 | SXMT120410SR-GM | 4 | 12,7x12,7 | 4,76 | 9° | 1 | 2 | XP2025 | ○ | ○ | ○ | ● | | | | | | | | | | |
| 7815023 | SXMT120410ER-SM | 4 | 12,7x12,7 | 4,76 | 9° | 1 | 2 | XC5035 | | | ○ | | | | | | | ○ | ○ | | | |
| 7816023 | SXMT120410ER-SM | 4 | 12,7x12,7 | 4,76 | 9° | 1 | 2 | XC5040 | | | ○ | | | | | | | ● | | | | |
| 7812022 | SXMT120410SR-GM | 4 | 12,7x12,7 | 4,76 | 9° | 1 | 2 | XC1015 | | | | | ● | ● | | | | | | | | |



CUTTING CONDITIONS

Milling | Indexables | Cutting conditions

PHC

High feed radius cutter

| | Work Material | Tensile Strength / Hardness | Vc (m/min) | Insert Size | | | | | | | | | | | | Grade |
|---|---|-----------------------------|---------------|--------------------------|-------|-------|-----------|--------------------------|-------|-----------|-------|--------------------------|-------|-------|-------|--------|
| | | | | SDMT07... | | | SDMT09... | | | SXMT12... | | | | | | |
| | | | | ap (mm) | | | ap (mm) | | | ap (mm) | | | | | | |
| | | | | Feed per Tooth fz (mm/t) | L/D=2 | L/D=3 | L/D=4 | Feed per Tooth fz (mm/t) | L/D=2 | L/D=3 | L/D=4 | Feed per Tooth fz (mm/t) | L/D=2 | L/D=3 | L/D=4 | |
| P | Mild Steel-Carbon Steel (S5400-S10C) | ~180HB | 180 (60~250) | 0,7 (0,3~1,5) | 0,8 | 0,6 | 0,4 | 0,8 (0,3~1,5) | 1 | 0,8 | 0,5 | 1,25 (0,5~3,2) | 1,2 | 1,2 | 1 | XP3035 |
| | Carbon Steel-Alloy Steel (S50C-SCM440) | ~280HB | 180 (60~250) | 0,7 (0,3~1,3) | 0,8 | 0,6 | 0,4 | 0,8 (0,3~1,5) | 1 | 0,8 | 0,5 | 1,25 (0,5~3) | 1,2 | 1,2 | 1 | XP3035 |
| | Die Steel (SKD11-SKD61) | ~280HB | 180 (60~250) | 0,7 (0,3~1,3) | 0,6 | 0,5 | 0,3 | 0,8 (0,3~1,5) | 0,8 | 0,6 | 0,4 | 1,25 (0,5~3) | 1,2 | 1,2 | 1 | XP3035 |
| M | Stainless Steel (Dry) (SUS304-SUS420) | ~250HB | 160 (80~200) | 0,4 (0,3~1,2) | 0,6 | 0,5 | 0,3 | 0,5 (0,3~1,5) | 0,8 | 0,6 | 0,4 | 1 (0,5~2,5) | 1,2 | 1 | 1 | XC5035 |
| | Stainless Steel (Coolant) (SUS304-SUS420) | ~250HB | 120 (60~180) | 0,4 (0,3~1,2) | 0,6 | 0,5 | 0,3 | 0,5 (0,3~1,5) | 0,8 | 0,6 | 0,4 | 1 (0,5~2,5) | 1,2 | 1 | 1 | XP2040 |
| K | Cast Iron (FC250) | ~350N/mm ² | 200 (100~300) | 0,8 (0,4~1,5) | 0,8 | 0,6 | 0,4 | 1 (0,5~1,8) | 1 | 0,8 | 0,5 | 1,5 (0,5~3,5) | 1,5 | 1,5 | 1 | XC1015 |
| | Ductile Cast Iron (FCD400) | ~800N/mm ² | 180 (100~250) | 0,7 (0,3~1,3) | 0,8 | 0,6 | 0,4 | 0,9 (0,5~1,5) | 1 | 0,8 | 0,5 | 1,35 (0,5~3) | 1,2 | 1,2 | 0,9 | XC1015 |
| S | Heat Resistant Alloys (Wet) (Inconel 718) | - | 30 (25~60) | 0,3 (0,2~0,7) | 0,4 | 0,4 | 0,3 | 0,4 (0,2~0,8) | 0,5 | 0,5 | 0,4 | 0,5 (0,2~1) | 1 | 1 | 0,8 | XC5040 |
| | Titanium Alloy (Wet) (Ti-6Al-4V) | - | 80 (50~120) | 0,4 (0,3~0,8) | 0,4 | 0,4 | 0,3 | 0,5 (0,3~1) | 0,5 | 0,5 | 0,3 | 0,7 (0,3~1,2) | 0,8 | 0,8 | 0,4 | XC5040 |
| H | Pre-hardened Steel (NAK80) | 40~43HRC | 120 (40~150) | 0,4 (0,2~0,8) | 0,4 | 0,4 | 0,3 | 0,5 (0,2~1) | 0,5 | 0,5 | 0,3 | 0,8 (0,3~1,5) | 1 | 1 | 0,5 | XP2040 |
| | Steel for Die Casting (DAC55-DH31) | 43~48HRC | 90 (40~120) | 0,3 (0,2~0,6) | 0,4 | 0,4 | 0,3 | 0,4 (0,2~0,8) | 0,5 | 0,5 | 0,3 | 0,7 (0,3~1,2) | 0,7 | 0,7 | 0,5 | XP2040 |
| | Hardened Steel (SKD11) | 50~55HRC | 60 (40~90) | 0,2 (0,2~0,5) | 0,3 | 0,3 | 0,2 | 0,3 (0,2~0,7) | 0,3 | 0,3 | 0,2 | 0,5 (0,3~0,8) | 0,5 | 0,5 | 0,4 | XP2040 |

Maximum Ramping Angle (E)

| Insert Size | SPMT07... | | | SDMT09... | | | SXMT12... | | | | | |
|-------------|------------------|---------------------|--------|------------------|------------------|---------------------|-----------|------------------|------------------|---------------------|--------|------------------|
| | Ramping Angle E° | Helical Milling(mm) | | Helical Angle p° | Ramping Angle E° | Helical Milling(mm) | | Helical Angle p° | Ramping Angle E° | Helical Milling(mm) | | Helical Angle p° |
| | | D Min. | D Max. | | | D Min. | D Max. | | | D Min. | D Max. | |
| 16 | 5,9 | 22 | 31 | 4,5 | - | - | - | - | - | - | - | - |
| 17 | 4,9 | 24 | 33 | 3,6 | - | - | - | - | - | - | - | - |
| 18 | 4,2 | 26 | 35 | 3,1 | - | - | - | - | - | - | - | - |
| 20 | 3,2 | 30 | 39 | 2,3 | - | - | - | - | - | - | - | - |
| 21 | 2,8 | 32 | 41 | 2,0 | - | - | - | - | - | - | - | - |
| 22 | 2,6 | 34 | 43 | 1,8 | - | - | - | - | - | - | - | - |
| 25 | 2,0 | 40 | 49 | 1,3 | 3,6 | 35 | 48 | 3,1 | - | - | - | - |
| 26 | 1,8 | 42 | 51 | 1,1 | 3,1 | 37 | 50 | 2,6 | - | - | - | - |
| 28 | 1,6 | 46 | 55 | 1,0 | 2,6 | 41 | 54 | 2,1 | - | - | - | - |
| 30 | 1,4 | 50 | 59 | 0,8 | 2,2 | 45 | 58 | 1,9 | 7,9 | 40 | 58 | 6,5 |
| 32 | 1,3 | 54 | 63 | 0,7 | 2,0 | 49 | 62 | 1,7 | 7,2 | 44 | 62 | 6,1 |
| 33 | 1,2 | 56 | 65 | 0,6 | 1,8 | 51 | 64 | 1,5 | 6,4 | 46 | 64 | 4,4 |
| 35 | 1,1 | 60 | 69 | 0,5 | 1,6 | 55 | 68 | 1,4 | 4,4 | 50 | 68 | 3,7 |
| 40 | - | - | - | - | 1,2 | 65 | 78 | 1,0 | 2,9 | 60 | 78 | 2,5 |
| 50 | - | - | - | - | 0,9 | 85 | 98 | 0,8 | 1,5 | 80 | 98 | 1,3 |
| 63 | - | - | - | - | 0,8 | 111 | 124 | 0,7 | 1,1 | 106 | 124 | 0,9 |
| 80 | - | - | - | - | - | - | - | - | 1,3 | 140 | 158 | 1,1 |
| 100 | - | - | - | - | - | - | - | - | 0,7 | 180 | 198 | 0,6 |

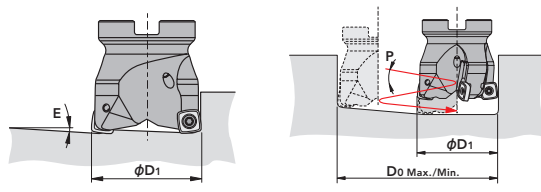

Flute shape dimensions (for programming)

| Insert size | R | ap max | R rt | Z |
|-------------|-----|--------|------|------|
| SPMT07... | 0,5 | 0,8 | 1,2 | 0,35 |
| SDMT09... | 0,8 | 1 | 2 | 0,7 |
| SXMT12... | 1 | 2 | 3 | 1,15 |

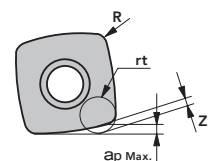

For machining purposes: create machining programs for the recommended simulated R. Unit: mm

Milling | Indexables

Cutting Conditions



www.osgeurope.com





shaping your dreams

OSG BELUX

Lavoisierlaan 1
B-1300 Z.I. Waver - Noord
België

Tel.: +32 10 23 05 11

Fax: +32 10 23 05 31

info@osg-belgium.com

12/2018 - All rights reserved. © OSG Europe 2018

The contents of this catalogue are provided to you for viewing only. They are not intended for reproduction either in part or in whole in this or other medium. They cannot be copied, used to create derivation work or used for any reason, by means without the express, written permission of the copyright owner. If prices are stated, they are netto unit-prices and any eventual tax(es) have to be added. The company is not responsible for any printing error in technical, price and/or any other data.

Tool specifications subject to change without notice.

www.osgeurope.com

